



Minispace 5071

Technical Specifications

› Structure

- Made of tube and steel plate arc welding with continuous wire.

› Polyurethane foam

- Seat density: 40 Kg/m³.
- Backrest density: 35-39 Kg/m³.

› Paint

- Electrostatic powder polyester paint.
- Paint Thickness: 70-80 microns.
- Grid adhesion according to UNE-EN ISO 2409 : 100%.

› Upholstery

- Reaction to fire standards:
 - Spain: UNE-EN 1021 Parts 1 and 2.
 - France: NF D 60-013.
 - Italy: UNI 9175 Class 1.IM.
 - Germany: DIN 66084.
 - USA: CAL TB117.

› Timber components

- Pressed beech plywood.

› Varnish

- Material: Bicomponent PU Varnish (water or solvent based)

› Aluminium

- Die cast aluminium alloy.
- Tensile strength (Rm)=240 Mpa.
- Elongation <1%.

› Fire resistance

- BS 5852. Clause12. Ignition sources 0,1 and 5. (with approved fabric).
- USA:CAL T.B. 133 (with approved fabric).

› Resistance and durability classification

- UNE-EN 12727 Level 4 (Severe use).

General Dimensions

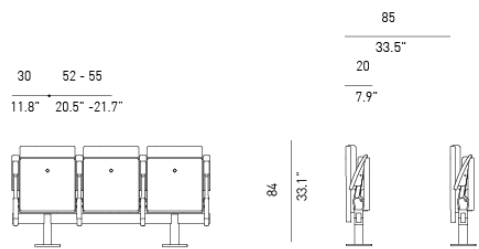

Minispace 5071

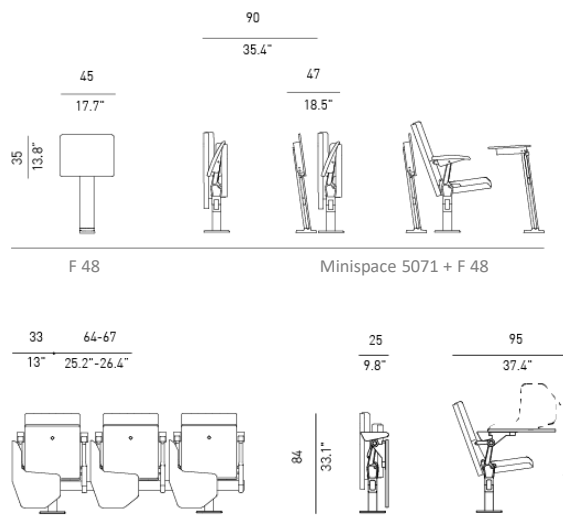

Minispace 5071PL

However, for the purpose of facilitating to the customer the latest novelties, FIGUERAS reserves the right to introduce the modifications and variations that it considers most appropriate and suitable for marketing its products.

General Description

› Space optimization seat. Natural wood and upholstery. Excellent acoustic performance. Occupies only 20 cm when folded.



· Folding seat arranged on bar.

· When the seat is rotated, the backrest is raised and inclined and the arms are placed in a horizontal position, in the same synchronized movement. The depth of the folded seat and backrest assembly is only 20 cm.



· The bending mechanism is produced by gravity without any type of spring. The set of seat, backrest and arms is supported by painted aluminium injection sides. Seat and backrest pivot on maintenance-free polyamide bushings.

· The automatic return of the seat is carried out with system of double rotula with springs and Controlled Soft Rise Technology System that avoids noises or annoying blows when returning the seat to its position of rest.

· The seat consists of a compact block of open-cell polyurethane foam. Fully upholstered and easily interchangeable. This block is inserted into a beech plywood board 13 mm thick, fireproof varnished, which acts as a protector of the back. The backrest has similar characteristics.

· The arms are made of internal metal structure, finished in varnished beech wood on the upper part.



· The sides that support the seat and backrest are joined to a rectangular steel tube structure. The foot, built in steel tube and finished in a circular plate, is fixed to the floor by means of the appropriate anchorage for each type of floor.

· The structures are presented in modules of 2, 3 or 4 seats. Curved rows can be formed by joining the modules in a polygonal shape.

· Reaction to fire: this product complies with international regulations.



However, for the purpose of facilitating to the customer the latest novelties, FIGUERAS reserves the right to introduce the modifications and variations that it considers most appropriate and suitable for marketing its products.

Materials and finishes

› Metal Parts Features

- The steel complies with the following European standards:
 - Tube up to 2mm thick: Alloy designation according to UNE-EN 10305 part 3: E-220.
 - Tube more than 2 mm thick: Alloy designation S275JR.
 - Plate: alloy designation according to EN 10111: DD12.

› Protection and Paint of Metal Parts

- Prior to powder coating, metal parts are treated with a three stage, non-acidic cleaning process to achieve superior finish adhesion. The finishing of the thermosetting polyester powder coating must be applied by electrostatic means with a minimum thickness of 70-80microns.
 - After coating, the parts must be oven cured to create a durable finishing that meets the following requirements:
 - Composition: Polyester powder suitable for outdoor use.
 - Cross Cut Test Adhesion according to UNE-EN ISO 2409 classification GT 0-1.
 - Scratch resistance according to ISO 15184:98 Level HB-H.
 - Total thickness: 70-80Microns.
 - Rust resistance (NSS), according to ISO 9220: 200 h.
 - Resistance to MEK 50 double rubs without paint stripping.

› Seat and Backrest Cushions Features

- The seat and backrest cushions are made of open-cell polyurethane foam.
 - The upholstery of the cushions is handcrafted, allowing all types of upholstery: fabrics, simile leather or natural leather. Within the range of products approved by Figueras.
 - This allows the seat to be customized according to each project's requirements.
 - Optionally, a fire barrier can be incorporated between the upholstery and the PUR foam.
 - They comply with all international fire behaviour requirements.
- Seat foam density: 40 kg/m³.
- Backrest foam density: 35-39kg/m³.

› Upholstery

• Comfort* Selection:

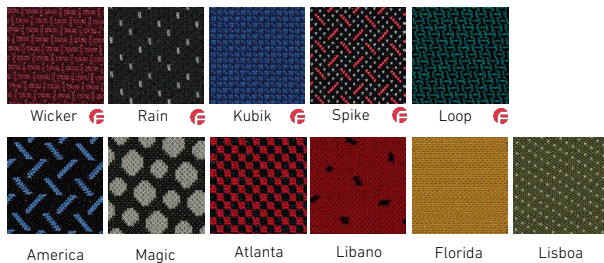

• Tech*



Valencia

• Leather*



Florencia

• Elegance* Selection:



(*) Fabric sample / printed by collection. Check available colours.

Figueras Fabrics® - Patented Design

› Finishes for wood parts

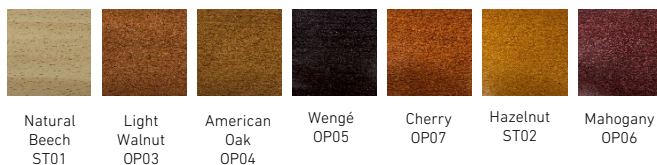

› Pigments for aluminium parts



Sablé 900

Ask our team for further available options